

**NEW!**

**SUPPLEMENT I - 2016 FOR YOUR  
CHAPMAN-HUFFMAN, INC. CATALOG**

Visit [WWW.CHAPMAN-HUFFMAN.COM](http://WWW.CHAPMAN-HUFFMAN.COM)

**INTENSITY SWITCH****12-620-00****\$50.00**

- Fits ADEC 6300 Wall, Track, Preference and Ceiling Mount dental Lights before serial number D415121
- Fits all RADIUS and CASCADE Lights
- Includes attached wires, installation instructions and connectors
- ADEC cross ref. # 90.1043.00

**POTENTIOMETER****12-030-00****\$21.80**

- 1W, 5K OHM Rating
- Flatted Shaft
- Fits ADEC CASCADE, DECADE and PERFORMER II & III chairs
- ADEC cross ref. # 041.372.00

**PUSH-BUTTON SWITCH****12-002-00****\$12.50**

- Fits ADEC Multi-Function Foot Switch - for auto-return and pre-positioning functions
- SPST 5A, 24VAC
- ADEC cross ref. # 041.059.00

**ROCKER SWITCH****12-003-00****\$13.40**

- Fits ADEC Multi-Function Foot Switch
- 10A, 125/250 VAC
- ADEC cross ref. # 041.119.00

**ADEC STYLE FOOT CONTROL II REPAIR KIT****95-288-00****\$15.90**

- Fits Foot Control II Valve (38.0607.01)
- ADEC cross ref. # 90.0312.00

**800-225-4621**

FAX 800-836-2765 • [WWW.CHAPMAN-HUFFMAN.COM](http://WWW.CHAPMAN-HUFFMAN.COM) • EMAIL: [ORDERS@CHAPMAN-HUFFMAN.COM](mailto:ORDERS@CHAPMAN-HUFFMAN.COM)

**S-1**

**CONTINENTAL SYRINGE WITH QUICK DISCONNECT TIP**

<i>Syringe Only</i>	<i>40-650-00</i>	<i>\$80.00</i>
---------------------	------------------	----------------

**SYRINGE WITH 7' STRAIGHT ASEPSIS TUBING**

<i>Black</i>	<i>40-656-00</i>	<i>\$90.00</i>
--------------	------------------	----------------

<i>Gray</i>	<i>40-657-00</i>	<i>\$90.00</i>
-------------	------------------	----------------

<i>Surf</i>	<i>40-658-00</i>	<i>\$90.00</i>
-------------	------------------	----------------

<i>Sterling</i>	<i>40-659-00</i>	<i>\$90.00</i>
-----------------	------------------	----------------

<i>Surf 6</i>	<i>40-660-00</i>	<i>\$90.00</i>
---------------	------------------	----------------

- Quick Disconnect Tip is released by pushing in on locking ring
- 360° tip rotation
- Locked-in cartridge style air/water buttons
- Precise mist, air, water control
- Matte chrome finish
- DCI cross ref. # 3450

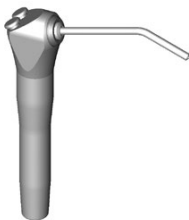
**VALVE CORE STYLE SYRINGE WITH QUICK DISCONNECT TIP**

<i>Syringe Only</i>	<i>40-500-00</i>	<i>\$80.00</i>
---------------------	------------------	----------------

**SYRINGE WITH COILED TUBING**

<i>Black Coiled</i>	<i>40-513-00</i>	<i>\$93.00</i>
---------------------	------------------	----------------

<i>Gray Coiled</i>	<i>40-514-00</i>	<i>\$93.00</i>
--------------------	------------------	----------------

<i>Surf Coiled</i>	<i>40-515-00</i>	<i>\$93.00</i>
--------------------	------------------	----------------

<i>Sterling Coiled</i>	<i>40-516-00</i>	<i>\$93.00</i>
------------------------	------------------	----------------

<i>Surf 6 Coiled</i>	<i>40-517-00</i>	<i>\$93.00</i>
----------------------	------------------	----------------

**SYRINGE WITH 7' STRAIGHT TUBING**

<i>Black Straight</i>	<i>40-506-00</i>	<i>\$90.00</i>
-----------------------	------------------	----------------

<i>Gray Straight</i>	<i>40-507-00</i>	<i>\$90.00</i>
----------------------	------------------	----------------

<i>Surf Straight</i>	<i>40-508-00</i>	<i>\$90.00</i>
----------------------	------------------	----------------

<i>Sterling Straight</i>	<i>40-509-00</i>	<i>\$90.00</i>
--------------------------	------------------	----------------

<i>Surf 6 Straight</i>	<i>40-510-00</i>	<i>\$90.00</i>
------------------------	------------------	----------------

- Quick Disconnect Tip is released by pushing in on locking ring
- Smooth contours for easy cleaning
- Traditional valve core design
- Uses standard autoclavable tips or disposable tips
- DCI cross ref. # 3470
- Made in Bend, Oregon, U.S.A.

# CHAPMAN-HUFFMAN, INC.

---

**PRESSURE HEAD ASSEMBLY WITH GAUGE**      **50-110-00**      **\$39.80**



- Includes 13 1/2" & 10" long water pick up tubes
- 10-32 mounting holes are 1" apart
- Accepts bottles w/28mm ALCOA thread
- White plastic construction
- Includes Gasket
- Includes mounting screws

---

**PRESSURE HEAD ASSEMBLY WITHOUT GAUGE**      **50-111-00**      **\$27.50**



- Includes 13 1/2" & 10" long water pick up tubes
- 10-32 mounting holes are 1" apart
- Accepts bottles w/28mm ALCOA thread
- White plastic construction
- Includes Gasket
- Includes mounting screws

---

**DOOR DAM-M9**      **20-452-00**      **\$38.20**



- Fits MIDMARK M9 sterilizer
- For door **WITHOUT** metal flap
- MIDMARK cross ref. # 053.0903.00

---

**SYRINGE REPAIR KIT**      **40-665-00**      **\$8.00**



- Fits Chapman-Huffman Inc. 40-650-00 Series Continental Syringe
- Fits DCI Quick Clean standard and continental syringes
- Non-autoclavable
- DCI cross ref. # 3066

---

**SYRINGE REPAIR KIT WITH 2 BUTTONS**      **40-666-00**      **\$18.00**



- Fits Chapman-Huffman Inc. 40-650-00 Series Continental Syringe
- Fits DCI Quick Clean standard and continental syringes
- Non-autoclavable
- DCI cross ref. # 3098

# CHAPMAN-HUFFMAN, INC.

## AIR BLEED RESTRICTOR BARB



<i>.005 Diameter (ADEC cross ref. # 023.036.00)</i>	<b>95-143-00</b>	<b>\$3.00</b>
<i>.013 Diameter (ADEC cross ref. # 023.070.00)</i>	<b>95-144-00</b>	<b>\$2.55</b>

- 10-32 Threads
- Includes Washer
- Brass Material
- Pkg. of 1

## TRUSS HEAD SLOT SCREW - PKG. OF 5

**95-066-00**

**\$12.00**



- #2-56 X 1/8" Long Stainless Steel
- Fits ADEC two-piece hydraulic manifolds to retain flow adjustment screws
- Pkg. of 5
- ADEC cross ref. # 001.002.01

## BUTTON HEAD SOCKET SCREW - PKG. OF 5

**95-067-00**

**\$8.00**



- #4-40 X 3/16" Long
- Fits ADEC one-piece hydraulic manifolds to retain flow adjustment screws
- Pkg. of 5
- ADEC cross ref. # 002.118.02

## BARB CROSS CONNECTOR - PLASTIC



*1/16" Barbs*

**14-235-00**

**\$2.00**

*1/8" Barbs*

**14-236-00**

**\$2.00**

- White nylon construction

## 3/8" OD TUBING RED POLYURETHANE



*Red - By the foot*

**10-403-00**

**\$1.60/ft.**

*Red - 100' Roll*

**10-403A-00**

**\$103.10**

*Red - 100' Spool*

**10-403S-00**

**\$107.40**

## 3/8" OD TUBING GREEN POLYURETHANE



*Green - By the foot*

**10-703-00**

**\$1.60/ft.**

*Green - 100' Roll*

**10-703A-00**

**\$103.10**

*Green - 100' Spool*

**10-703S-00**

**\$107.40**

**800-225-4621**

# CHAPMAN-HUFFMAN, INC.

---

## VALVE CORE SYRINGE BUTTON WITH SPRING



DCI cross ref. # 3093 (Pkg. of 1) 40-526-00 \$9.20  
DCI cross ref. # 3034 (Pkg. of 10) 40-527-00 \$88.00

- Fits Chapman-Huffman Inc. 40-500-00 series valve core style syringes
- Fits DCI 3470 Quick Clean valve core style syringes

---

## VALVE CORE SYRINGE REPAIR KIT



DCI cross ref. # 3076 40-529-00 \$8.20

- Fits Chapman-Huffman Inc. 40-500-00 series valve core style syringes
- Fits DCI 3470 Quick Clean valve core style syringes

---

## QUICK DISCONNECT TIP ADAPTOR KIT



DCI cross ref. # 3089 40-530-00 \$27.80

- Fits Chapman-Huffman Inc. 40-500-00 series valve core style syringes
- Fits DCI Quick Clean syringes
- Non-autoclavable

---

## VALVE CORE SYRINGE SPRING ONLY



DCI cross ref. # 9674 Pkg. of 1 40-528-00 \$1.40  
Pkg. of 10 40-533-00 \$10.00

- Fits Chapman-Huffman Inc. 40-500-00 series valve core style syringes
- Fits DCI Valve Core Style Syringes

---

## SYRINGE BUTTON CONICAL SPRING ONLY



DCI cross ref. # 9670 (Pkg. of 1) 40-226-00 \$1.50  
ADEC cross ref. # 013.064.01 (Pkg of 10) 40-227-00 \$12.50

- Fits Chapman-Huffman Inc. 40-200-00, 40-250-00, 40-300-00, 40-600-00, 40-650-00, 40-700-00, 40-800-00, 40-850-00 and 40-900-00 series syringes
- Fits DCI Quick Clean and autoclavable syringes with cartridge type buttons
- Fits ADEC cartridge type syringes

**800-225-4621**

FAX 800-836-2765 • WWW.CHAPMAN-HUFFMAN.COM • EMAIL: [ORDERS@CHAPMAN-HUFFMAN.COM](mailto:ORDERS@CHAPMAN-HUFFMAN.COM)

---

## AUTOCLAVABLE SYRINGE BUTTON WITH CONICAL SPRING



*Pkg. of 1*  
*Pkg. of 10*

**40-225-00 \$11.00**  
**40-224-00 \$100.00**

- Fits DCI Autoclavable standard and continental syringes
- DCI cross ref. # 3086

---

## AUTOCLAVABLE SYRINGE REPAIR KIT

**40-228-00**

**\$9.80**



- Fits DCI Autoclavable standard and continental syringes
- DCI cross ref. # 3045

---

## AUTOCLAVABLE VALVE CORE SYRINGE BUTTON WITH SPRING

**40-531-00**

**\$9.20**

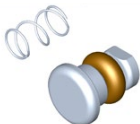

- Fits DCI Autoclavable valve core style syringes
- DCI cross ref. # 3092

---

## AUTOCLAVABLE VALVE CORE SYRINGE REPAIR KIT

**40-532-00**

**\$8.80**



- Fits DCI Autoclavable valve core style syringes
- DCI cross ref. # 3072

---

## SYRINGE BUTTON WITH CONICAL SPRING



*DCI cross ref. # 3085 (Pkg. of 1)* **40-216-00 \$9.00**  
*DCI cross ref. # 3099 (Pkg of 10)* **40-217-00 \$86.00**

- Fits Chapman-Huffman Inc. 40-200-00, 40-250-00, 40-650-00 Syringes
- Fits DCI QuickClean Standard and Continental Syringes
- Non-autoclavable

# CHAPMAN-HUFFMAN, INC.

---

**1/2" PLASTIC HOLE PLUG**

**95-072-00**

**\$2.50**



- White Color
- Fits ADEC 311 Chair
- Pkg. of 1
- ADEC cross ref. # 018.002.06

---

**10-32 HEX PLUG - PLATED PKG. OF 100**

**95-627-00**

**\$36.00**



**800-225-4621**

FAX 800-836-2765 • WWW.CHAPMAN-HUFFMAN.COM • EMAIL: [ORDERS@CHAPMAN-HUFFMAN.COM](mailto:ORDERS@CHAPMAN-HUFFMAN.COM)

S-7

**CHAPMAN-HUFFMAN, INC.**

***SERVING THE DENTAL INDUSTRY SINCE 1979***

***800-225-4621***

***(541) 382-7869***

***FAX 800-836-2765***

***FAX (541) 382-4999***

***EMAIL: [ORDERS@CHAPMAN-HUFFMAN.COM](mailto:ORDERS@CHAPMAN-HUFFMAN.COM)***

***[WWW.CHAPMAN-HUFFMAN.COM](http://WWW.CHAPMAN-HUFFMAN.COM)***

***320 S.E. BRIDGEMORE BLVD. SUITE 1  
BEND, OREGON 97702***